

## OSM/LUM DECISION SHEET (DSH)

Standard(s) (incl. year)	Subclause(s):	Tracking No.	Year
EN 60598-1:2015/A1:2018	9.2	DSH 2003A	2019
<b>Category:</b>			
LITE			
Subject:	Key words:	Developed by	Approved at
IP 6X	<ul style="list-style-type: none"> <li>- Luminaire enclosure</li> <li>- Talcum deposit</li> <li>- Outer surface of the LED module</li> </ul>	OSM/LUM-ETF5	2019 ETICS Plenary Meeting

### Question

The LED module “inside” the enclosure for a road and street lighting is classified  $\geq$  IP 6X. All electrical parts and components are enclosed and protected inside the LED module. The enclosure consists of a metal cover which protects the LED module against contaminations such as bird droppings, leaves, pine cones etc. After the dust test, talcum powder is deposited on the outer surface of the LED module inside the cover. Is the luminaire considered as complying with IP 6X requirements?

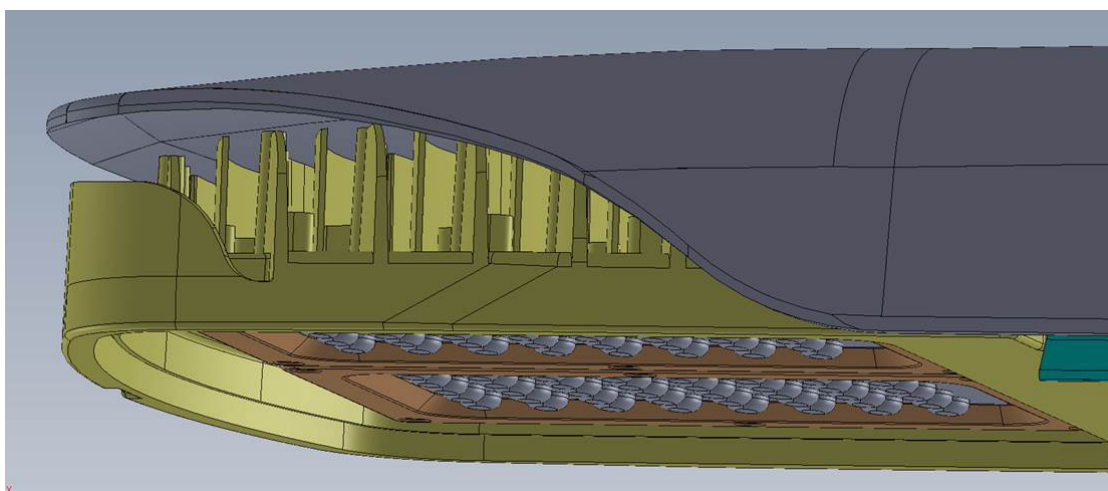
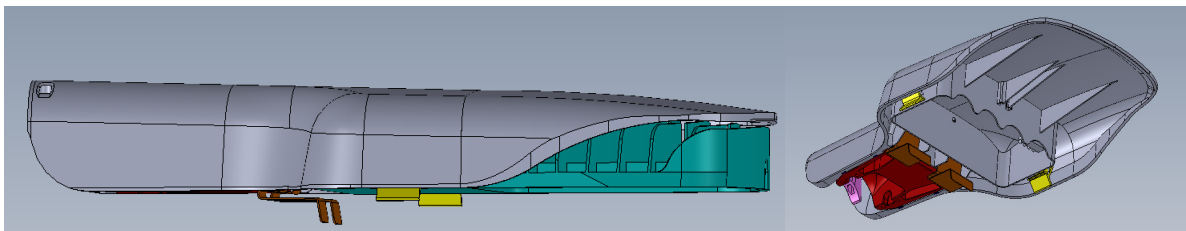

**Decision**

The luminaire complies with the IP 6X requirements, since the outer surface of the LED module is considered as the outer surface of the luminaire.

Note: for EN 60598-2-24 the outside of the LED module has also to be considered for temperature limit.

**Explanatory notes**

---